

Estimation of Controlled Burn Coverage

NATL UP Blocks A, B, C, D, E

Date of burn 3/2/16

Burn master Tom Workman

Date of coverage estimate 3/15/16

Estimator Ross Danson

Estimated coverage C = 95%, D = 85%
E = 85%, A = 100%, B = 100%

Methods:

- Estimate coverage in each whole or partial quarter gridblock to the nearest 10% unless too close to call (then use nearest 5%).
- Calculations are made with a [spreadsheet](http://natl.ifas.ufl.edu/docs/BurnCoverage2013-date.xlsx) (at <http://natl.ifas.ufl.edu/docs/BurnCoverage2013-date.xlsx>).

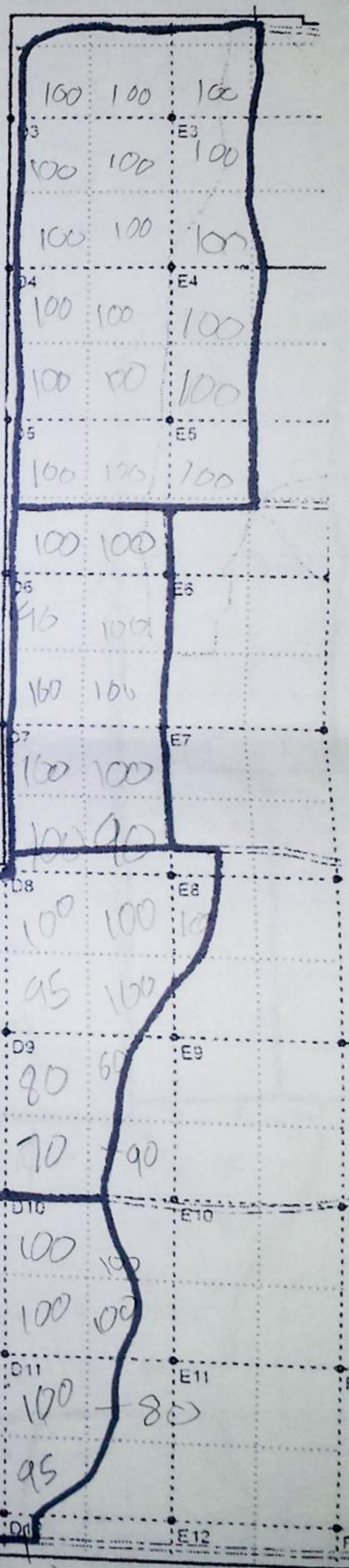

Crossed out are the educational plots.

