

Pines and grid map of Block A of NATL's Upland Pine Ecosystem

Numbers are diameters (DBH) in centimeters as measured in 2008. Trees last censused in March 2013.

This block was formerly known as nPAP (north Public Area Pine).

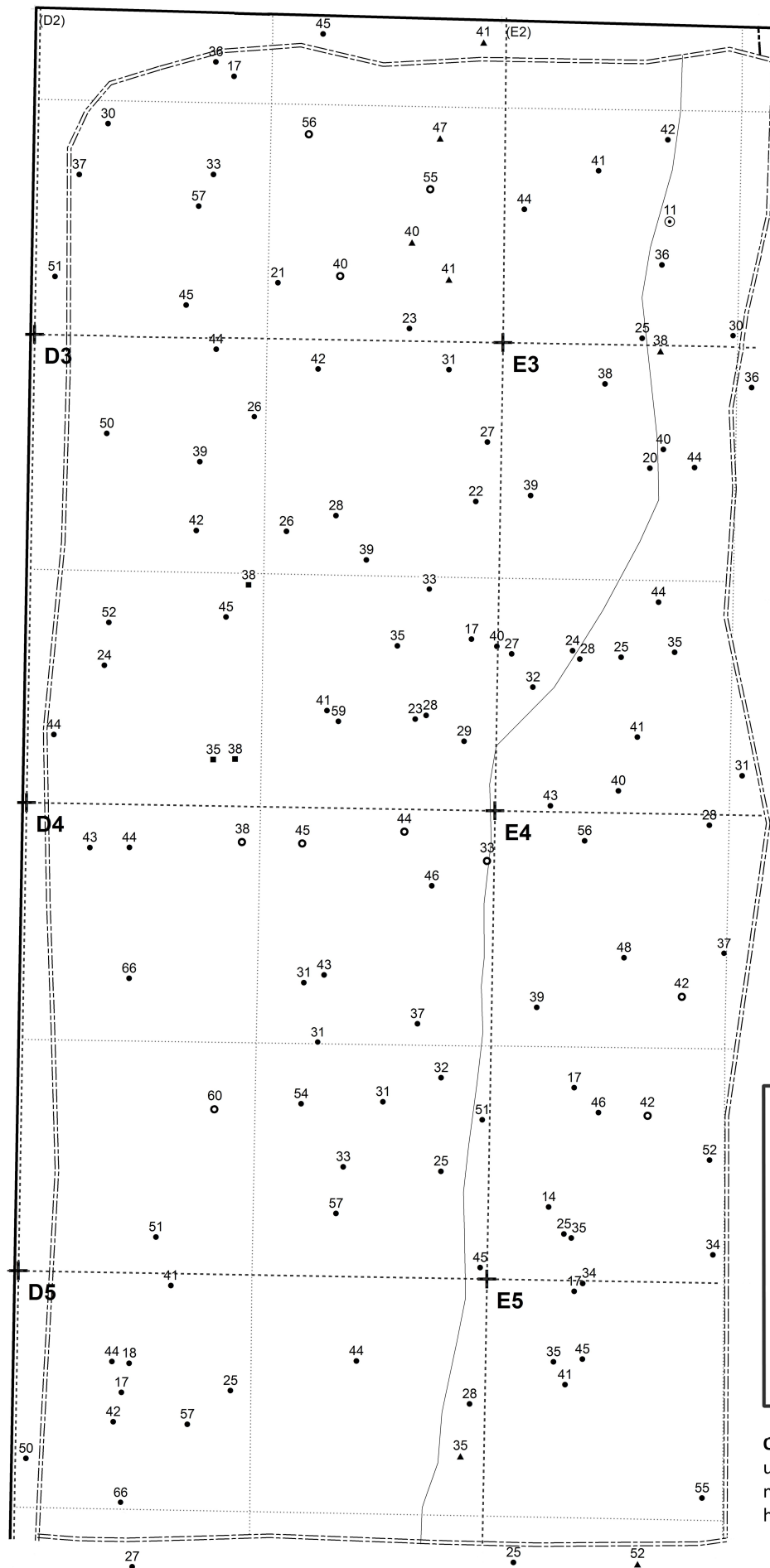

Key

- legacy longleaf
- ⊙ recent longleaf
- ▲ loblolly
- slash pine
- ⊘ pine snag
- ⊕ grid stake
- - - grid lines (50m)
- ⋯ grid lines (25m)
- - - major trail
- nature trail
- · - other trail

Grid blocks: Each 50x50m grid block is defined by a grid stake at each corner and is named after the stake in its NW corner. On this map each grid block is divided into a NW, NE, SE, and SW 25x25m "quarter grid block." The grid stakes are at permanently surveyed points. The other three corners of each ¼ grid block may be marked with temporary stakes that were located by measuring from the surveyed points.

Online data: Each surveyed pine tree in NATL has a unique "P-" number. For the P-number map that matches this map and additional data, go to <http://natl.ifas.ufl.edu/maps/pinmaps.php#upmaps>.