

# Pines and grid map of Block B of NATL's Upland Pine Ecosystem

Numbers are diameters (DBH) in centimeters as measured in 2008. Trees last censused in March 2013.

This block was formerly known as sPAP (south Public Area Pine).

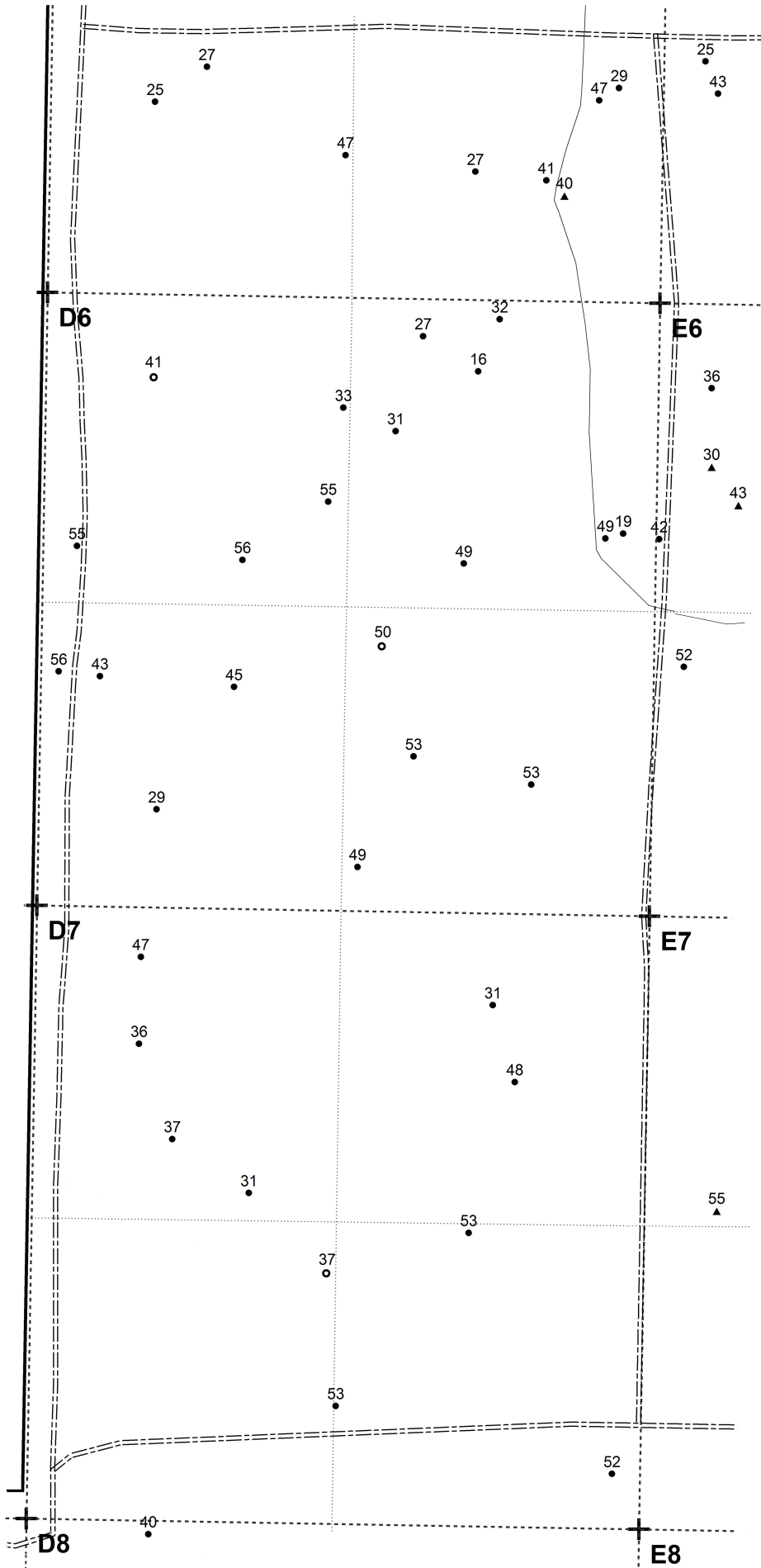

**Key**

- legacy longleaf
- ⊙ recent longleaf
- ▲ loblolly
- slash pine
- ⊗ pine snag
- ⊕ grid stake
- - - grid lines (50m)
- ⋯ grid lines (25m)
- === major trail
- nature trail
- - - other trail

**Grid blocks:** Each 50x50m *grid block* is defined by a *grid stake* at each corner and is named after the stake in its NW corner. On this map each grid block is divided into a NW, NE, SE, and SW 25x25m “quarter grid block.” The grid stakes are at permanently surveyed points. The other three corners of each ¼ grid block may be marked with temporary stakes that were located by measuring from the surveyed points.

**Online data:** Each surveyed pine tree in NATL has a unique “P-” number. For the P-number map that matches this map and additional data, go to <http://natl.ifas.ufl.edu/maps/pinmaps.php#upmaps>.