

NATL flammable-grass pickup schedule										
					8-Jun	15-Jun	18-Jun	30-Jun	total	totals
Common name	Scientific name	No.	Price	Total	pick-up	pick-up	pick-up	pick-up	ACT	NATL
wiregrass	<i>Aristida beyrichiana</i>	4200	0.40	\$1,680	1000	1000	0	0	2200	2000
lopsided indiagrass	<i>Sorghastrum secundum</i>	1400	0.40	560	0	0	1000	400	0	1400
Elliott's lovegrass	<i>Eragrostis elliottii</i>	175	0.40	70	0	0	0	175	0	175
Purple lovegrass	<i>Eragrostis spectabilis</i>	175	0.40	70	0	0	0	175	0	175
Muhlygrass	<i>Muhlenbergia capillaris</i>	50	0.40	20	0	0	0	50	0	50
	Grand total	6000		\$2,400						
			NATL will pay	\$1,520						
	Alachua Conservation Trust will pay			\$880						
Because the restoration of Block C was at an earlier stage than anticipated when NATL ordered the plugs in March, NATL looked for someone who could use wiregrass plugs in excess of what NATL required. ACT proved to have a longleaf tract that needed such plugs.										

# Information sheet for those planting wiregrass plugs in Blocks D and E of NATL's Upland Pine

9-19 June 2015  
 ~ 900 planted in D  
 ~ 900 planted in E

## Suggestions for getting started

- If you are not a wiregrass planter with experience in NATL, pair up with someone who is.
- If you are experienced, look for someone who needs you as a partner.
- When working with a partner the usual procedure is for one to select the planting spots and operate the dibble, while the other carries and places the plugs and closes each planting. Partners switch jobs when either one tires.

## Rules for planting wiregrass

- Maintain 1 meter or more between wiregrass plants (including established ones).
- Closing the planting of a plug requires that the leaves are above the soil surface and the roots are below that surface with soil against all sides.

## Why different numbers of plugs per 1/4-block?

Dropped pine needles are ideal fire carriers for controlled burns, but areas without pine trees need other flammables to carry a fire. When mature, wiregrass will catch fire easily and burn hotly. After the controlled burn of 12Feb2015, unburned areas were estimated in each 1/4-gridblock in Blocks D and E. The 1/4-blocks were assigned larger numbers of grass plugs in proportion to their unburned areas.

## Navigation by grid stakes

### Determining your location on the map below

The stakes that mark the corners of the 50x50m "main" grid blocks are the only stakes that are metal with a 10ft flagged pole attached. Each metal stake has a dark green band with a letter and a number—for example, B11. Whenever you are at a main gridstake within the area mapped below, you can find your exact location on the map.

### Finding an assigned 1/4-gridblock

You will be assigned to plant grass plugs in one of the four 25x25m 1/4-gridblocks in a particular main gridblock. If you find the metal stake that is at one corner of your 1/4-grid block, and know the direction of north, the map below should be sufficient to find your assigned gridblock. *Hint:* Verify that you are where you think you are by seeing if the nearest plastic stakes to the north and south have **blue** bands of color and the ones to the east and west have **yellow** bands of color.

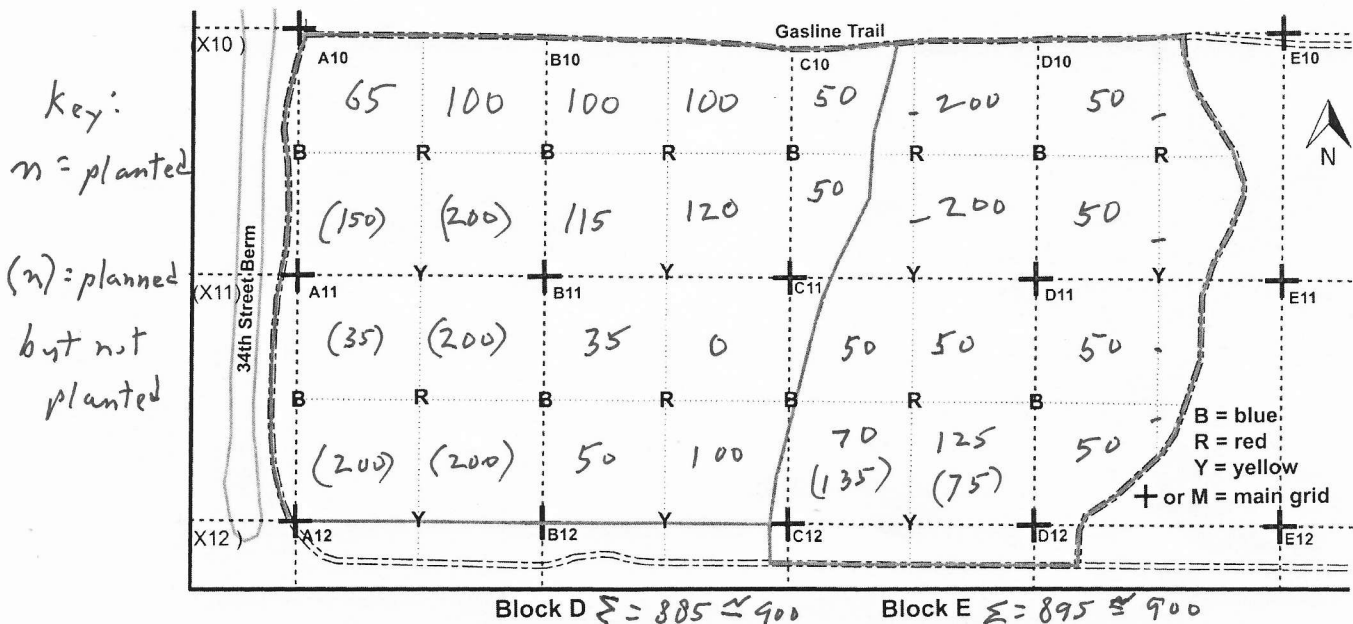

**Information sheet for those planting lopsided Indiangrass plugs  
in Block D of NATL's Upland Pine**

24 June 2015  
~ 1000 planted in D

**Suggestions for getting started**

- If you are not a grass-plug planter with experience in NATL, pair up with someone who is.
- If you are experienced, look for someone who needs you as a partner.
- When working with a partner the procedure is often for one to select the planting spots and operate the dibble, while the other carries and places the plugs and closes each planting. Partners switch jobs when either one tires.

**Rules for planting Indiangrass plugs**

- Plant plugs no closer than 1.5 meters to a gridline
- Maintain a distance of 1 meter or more between planted plugs.
- Closing the planting of a plug requires that the leaves are above the soil surface and the roots are below that surface with soil against all sides. (The soil surface is below the duff.)

**Navigation by grid stakes**

*Determining your location on the map below*

The stakes that mark the corners of the 50x50m "main" grid blocks are the only stakes that are metal with a 10ft flagged pole attached. Each metal stake has a dark green band with a letter and a number—for example, **B11**. Whenever you are at a main gridstake within the area mapped below, you can find your exact location on the map.

*Finding an assigned 1/4-gridblock*

You will be assigned to plant grass plugs in one of the four 25x25m 1/4-gridblocks in a particular main gridblock. If you find the metal stake that is at one corner of your 1/4-grid block, and know the direction of north, the map below should be sufficient to find your assigned gridblock.

*Note:* The letters on the map indicate the colors of the gridstakes: **Blue, Red, Yellow or Metal**.

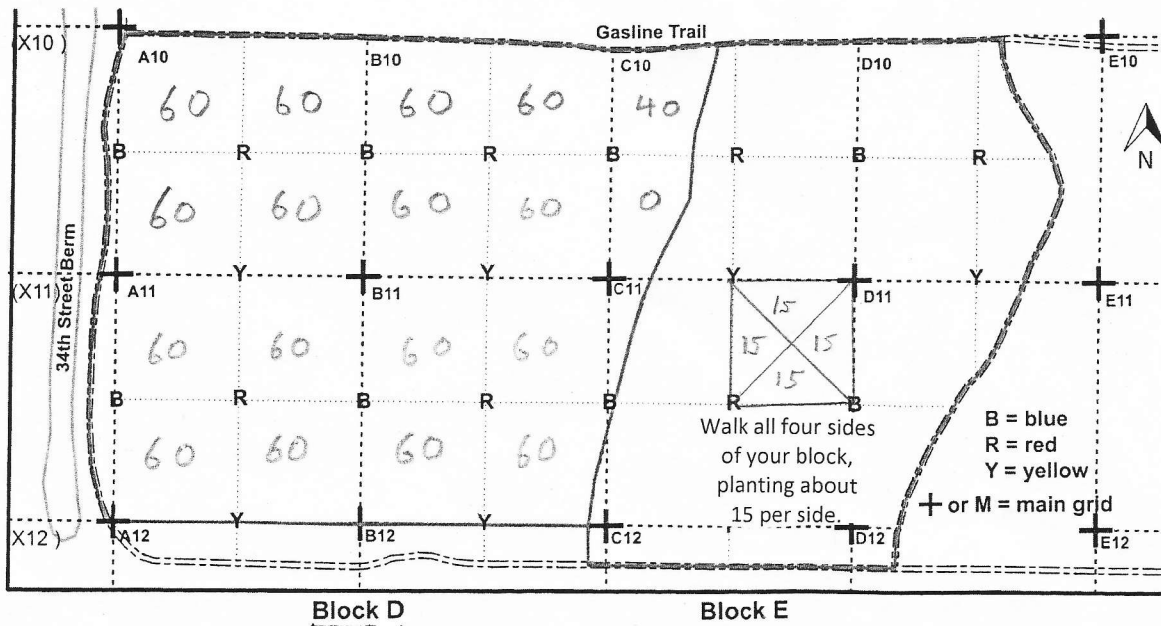

1 July 2015

~ 120 planted

## Planting plan for purple lovegrass plugs in Block D of Upland Pine

### Rules for planting Indiangrass plugs

- Plant plugs no closer than 1.5 meters to a gridline
- Maintain a distance of 1 meter or more between planted plugs.
- Closing the planting of a plug requires that the leaves are above the soil surface and the roots are below that surface with soil against all sides. (The soil surface is below the duff.)

### Where to plant

- Block C: along each B-R-B gridline, plant 5 to the North and 5 to the south in each 25 meter segment as indicated below. (Plant immediately beyond ROW for the gridline.): **152**
- KP and TW will plant remaining plugs in grass gardens near center of each ¼-grid block of Block C and elsewhere.

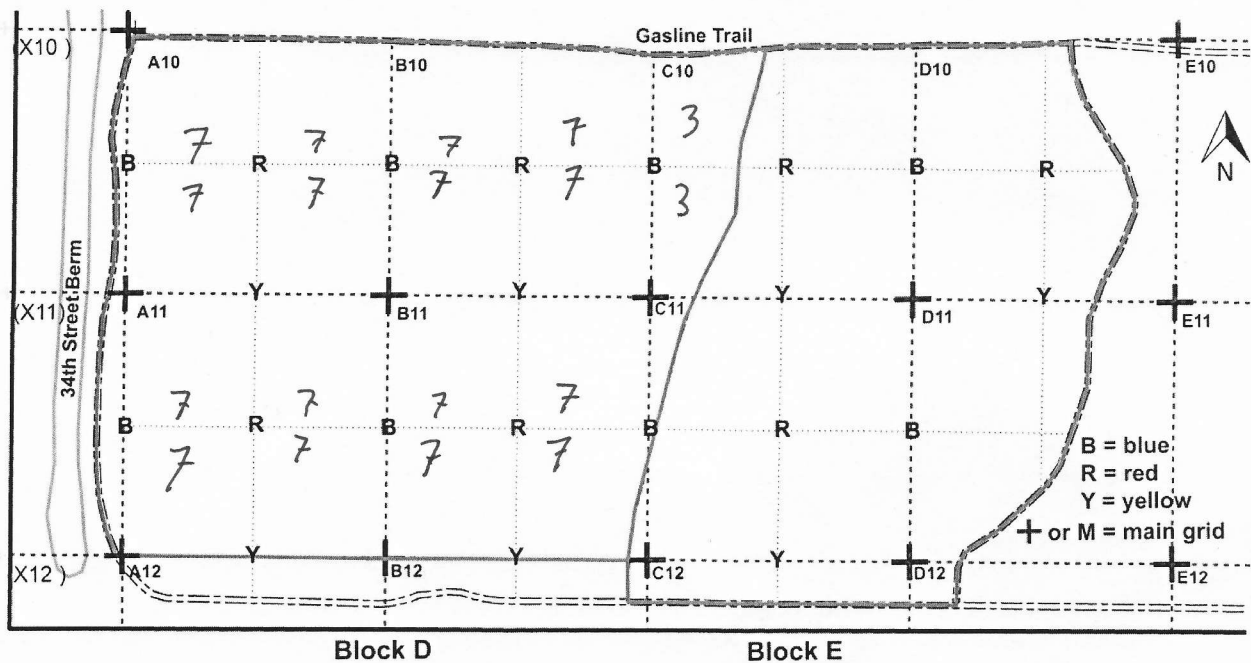

# Planting plan for Grass Gardens in Block C of Upland Pine

Planted 2 July 2015  
by KP&TW

## Rules for planting plugs

- Plant plugs no closer than 1.5 meters to a gridline
- Maintain a distance of 1 meter or more between planted plugs.
- Closing the planting of a plug requires that the leaves are above the soil surface and the roots are below that surface with soil against all sides. (The soil surface is below the duff.)

## Where to plant

- One Grass Garden in the approximate center of each of the 30 ¼-gridblocks of Block C.
- Each Grass Garden planted with these plugs:
  - 2 lopsided Indiangrass
  - 2 purple lovegrass
  - 2 Elliott's lovegrass
  - 1 Muhlygrass.
- Plugs are planted in the same pattern in each Garden:

ELG = 56  
LIG = 56  
PLG = 56  
MG = 28

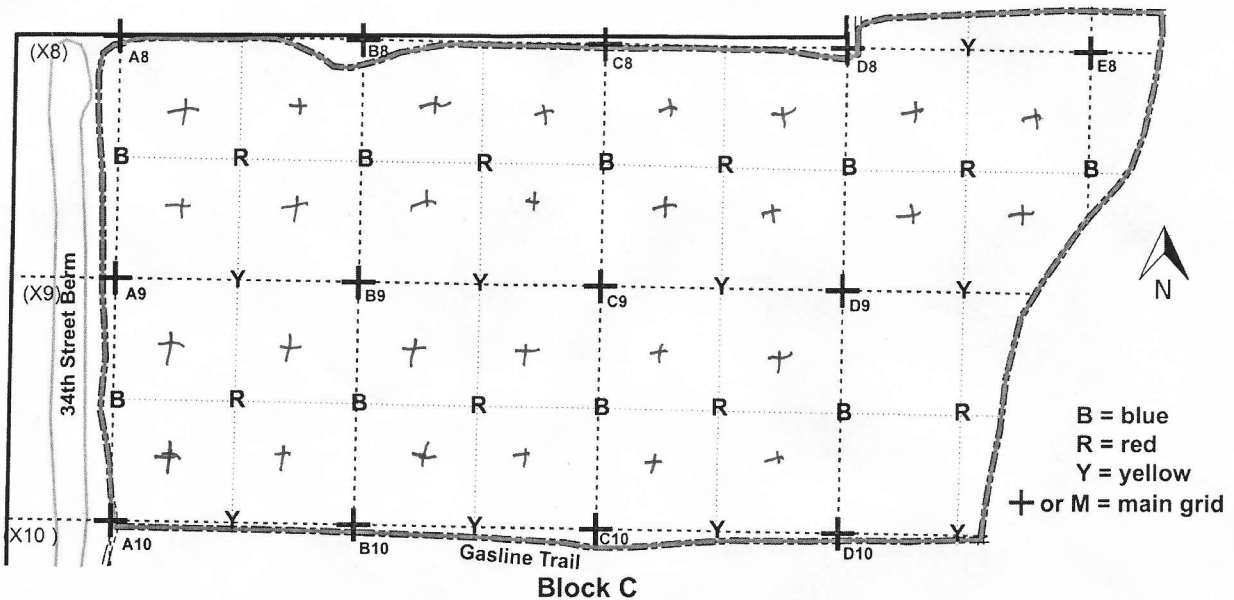
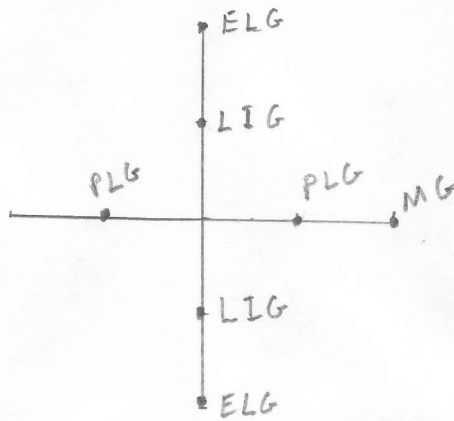

# Planting plan for Muhly grass plugs in Block E of Upland Pine

3 July 2015

22 plugs

## Rules for planting Indiangrass plugs

- Plant plugs no closer than 1.5 meters to a gridline
- Maintain a distance of 1 meter or more between planted plugs.
- Closing the planting of a plug requires that the leaves are above the soil surface and the roots are below that surface with soil against all sides. (The soil surface is below the duff.)

## Where to plant

- Block E: along north R-B-R gridline, plant 4 to the north and 4 to the south in each 25 meter segment as indicated below. (Plant immediately beyond ROW for the gridline.): **16**
- TW will plant remaining plugs in grass garden in E

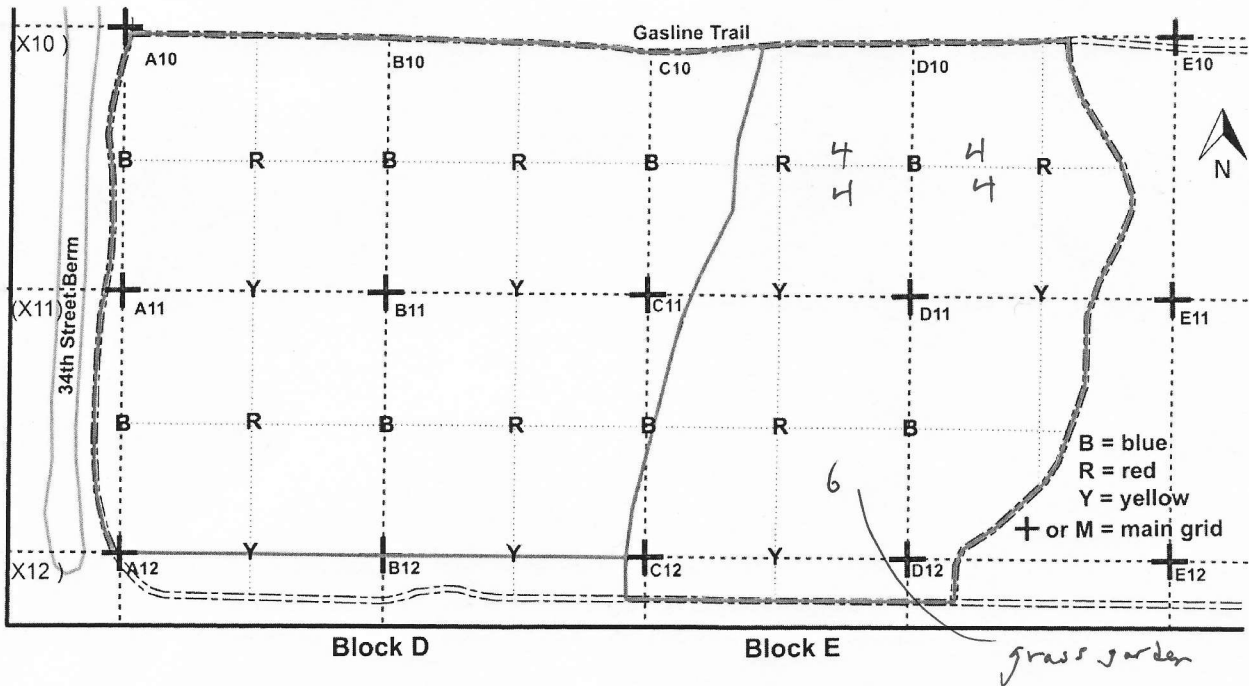

3-4 July 2015  
 ~110 plugs

## Planting plan for lopsided indiagrass plugs in Block E of Upland Pine

### Rules for planting Indiagrass plugs

- Plant plugs no closer than 1.5 meters to a gridline
- Maintain a distance of 1 meter or more between planted plugs.
- Closing the planting of a plug requires that the leaves are above the soil surface and the roots are below that surface with soil against all sides. (The soil surface is below the duff.)

### Where to plant

- Block E: along R-B-R gridlines, plant 5 to the north and 5 to the south in each 25 meter segment as indicated below. **50**
- Block E: along R-Y-R gridlines, plant 4 or 5 to the west and 4 or 5 to the east in each 25 meter segment as indicated below. **62**

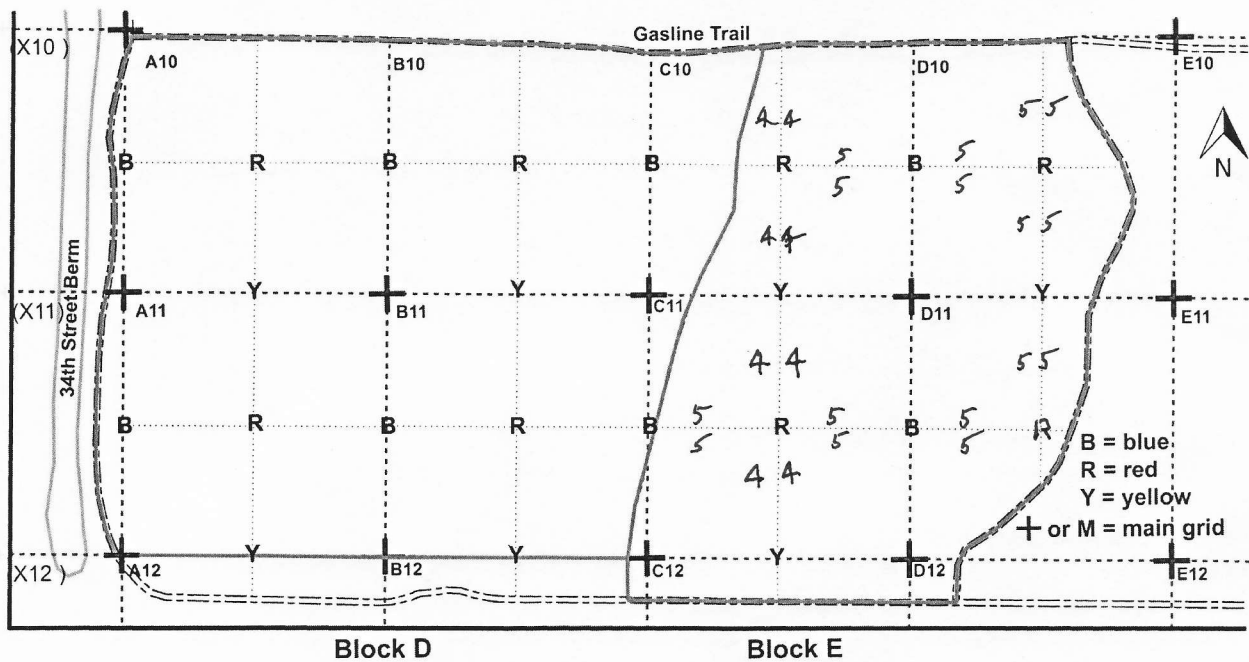

# Planting plan for Elliott's lovegrass plugs in Block D of Upland Pine

6 July 2015

## Rules for planting grass plugs

- Plant plugs no closer than 1.5 meters to a gridline
- Maintain a distance of 1 meter or more between planted plugs.
- Closing the planting of a plug requires that the leaves are above the soil surface and the roots are below that surface with soil against all sides. (The soil surface is below the duff.)

~120 plugs planted

## Where to plant

- Block D: along each B-R-B gridline, plant 7 to the North and 7 to the south in each 25 meter segment as indicated below. (Plant anywhere beyond ROW for the gridline.):  
**118 plugs**

